

CAD **PKVD**
Branch Triple Double

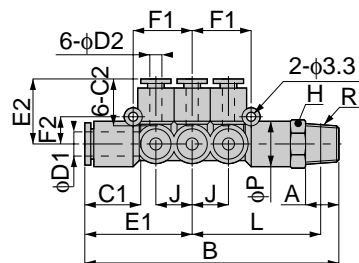

unit:mm

Model	Tube dia. φD1	Tube dia. φD2	R	A	B	L	φP1	C1	C2	J	E1	E2	H	F1	F2
PKVD 8-4-02	8	4	R1/4	11	81	40	15	18	16	12	35	21	14	20	9
PKVD 8-4-03			R3/8	12	82.5	41.5							17		
PKVD 8-6-02		6	R1/4	11	81	40			17			14			
PKVD 8-6-03			R3/8	12	82.5	41.5						17			
PKVD 10-6-03	10	6	R3/8	12	93.5	46.5	17.5	20	17	14	40.5	24	17	23	10.5
PKVD 10-6-04			R1/2	15	96.5	48							21		
PKVD 10-8-03		8	R3/8	12	93.5	46.5			18			17			
PKVD 10-8-04			R1/2	15	96.5	48						21			

Model	Mass (g)	Orifice (φmm)	Eff. a. (mm ²)
PKVD 8-4-02	44.5	3	4.5
PKVD 8-4-03	58.5		4.6
PKVD 8-6-02	46	4.6	10.2
PKVD 8-6-03	59.5		10.3
PKVD 10-6-03	70	4.6	10.6
PKVD 10-6-04	91		11.1
PKVD 10-8-03	73	7	20.6
PKVD 10-8-04	94		19.4

CAD **PVU**
Tripod Union

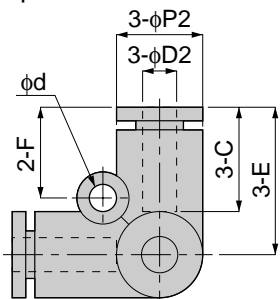

unit:mm

Model	Tube dia. φD	φP	C	E	φd	F	Mass (g)	Orifice (φmm)	Eff. a. (mm ²)
PVU 4	4	10	15	17	3.2	10.5	7.5	3	3.7
PVU 6	6	12.5	17	20.5	4.2	12.5	10.5	4.6	8.3
PVU 8	8	14.5	18	22.5	4.2	12.5	15	6	16
PVU 10	10	18	20	26.5	4.2	14.5	25.5	8	30.2
PVU 12	12	21.5	23.5	29.5	4.2	15.5	36	10	40.2

CAD **PVX**
Tripod Elbow

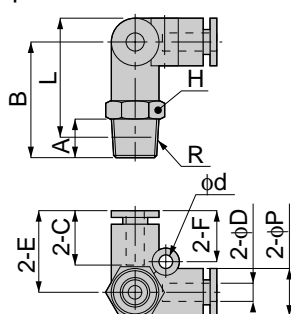

Metric thread type



unit:mm

Model	Tube dia. φD	R	A	B	L	φP	C	E	H	φd	F	Mass (g)	Orifice (φmm)	Eff. a. (mm ²)
PVX 4-M5	4	M5×0.8	3	21.5	24.5	10	15	17	10	3.2	10.5	11.5	1.8	2.3
PVX 4-M6		M6×1	4	22.5								12		3.6
PVX 4-01		R1/8	8	24.5	25.5							14.5	3	4
PVX 4-02		R1/4	11	27.5	26.5							23.5		3.5
PVX 6-M5	6	M5×0.8	3	25.5	29	12.5	17	20.5	12	4.2	12.5	16	1.8	2.3
PVX 6-M6		M6×1	4	26.5								14.5		3
PVX 6-01		R1/8	8	28.5	30.5							18	4	8.5
PVX 6-02		R1/4	11	31.5	31.5							25.5		8
PVX 6-03	R3/8	12	33	32.5	39	8.4								
PVX 8-01	8	R1/8	8	30.5	33.5	14.5	18	22.5	14	4.2	12.5	23.5	6	17.1
PVX 8-02		R1/4	11	33.5	34.5							29.5		17.5
PVX 8-03		R3/8	12	35	35.5							42		17.4
PVX 10-02	10	R1/4	11	38	40.5	17.5	20	26.5	17	4.2	14.5	43.5	8	31.5
PVX 10-03		R3/8	12	39	41							52		28.1
PVX 10-04		R1/2	15	42	42.5							73		24.3
PVX 12-02	12	R1/4	11	41	45.5	21	23.5	29.5	21	4.2	15.5	64	8	40.9
PVX 12-03		R3/8	12	42	46							64.5		45
PVX 12-04		R1/2	15	45	47.5							79.5		44.8