

PAT

Triple Branch A

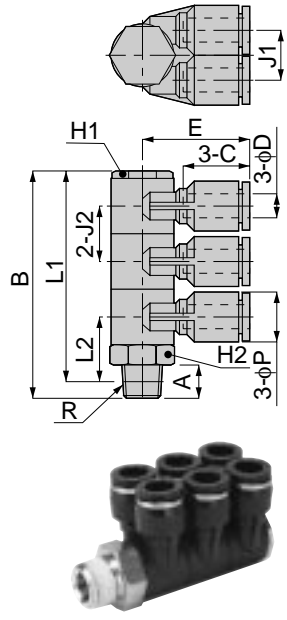

unit:mm

Model	Tube dia. φD	R	A	B	L1	L2	φP	C	J1	J2	E	H1	H2	Mass (g)	Orifice (φmm)	Eff. a. (mm ²)
PAT 4-01	4	R1/8	8	57	53	16	10	15	10	14	22.5	14	14	43.5	3	4.8
PAT 4-02		R1/4	11	60	54	17								46.5		4.4
PAT 4-03		R3/8	12	62	55.5	18.5								56.5		4.2
PAT 6-01	6	R1/8	8	57	53	16	12.5	17	12	14	26.5	14	14	49.5	4.6	6.7
PAT 6-02		R1/4	11	60	54	17								52.5		6.8
PAT 6-03		R3/8	12	62	55.5	18.5								62.5		
PAT 8-01	8	R1/8	8	61	57	17.5	14.5	18.5	14	15	29.5	17	17	71	5.1	13.3
PAT 8-02		R1/4	11	64	57.5	18.5								74		13.5
PAT 8-03		R3/8	12	65	58.5	19								79		13.9
PAT 8-04		R1/2	15	70	62	22.5								102		14
PAT 10-02	10	R1/4	11	75.5	69.5	22	17.5	20.5	17	18	34	22	22	127.5	6.5	21.3
PAT 10-03		R3/8	12	76.5	70	22.5								134		22
PAT 10-04		R1/2	15	79.5	71.5	24								142		22
PAT 12-02	12	R1/4	11	88	82	26.5	21	23.5	20	21	37.5	27	27	207.5	7.7	43.1
PAT 12-03		R3/8	12	89	82.5	27								215		44.8
PAT 12-04		R1/2	15	92	84	28.5								222		45.8
PAT 1/4-01	1/4	R1/8	8	57	53	16	12.5	17	12	14	26.5	14	14	49.5	4.6	7
PAT 1/4-02		R1/4	11	60	54	17								52.5		7.2
PAT 1/4-03		R3/8	12	62	55.5	18.5								62.5		7.1
PAT 5/16-02	5/16	R1/4	11	64	57	18.5	14.5	18.5	14	15	29.5	17	17	74	5.1	13.5
PAT 5/16-03		R3/8	12	65	57.5	19								79		13.9
PAT 5/16-04		R1/2	15	70	58.5	22.5								102		14
PAT 3/8-02	3/8	R1/4	11	75.5	69.5	22	17.5	20.5	17	18	34	22	22	129	6.5	20.5
PAT 3/8-03		R3/8	12	76.5	70	22.5								134		20.8
PAT 3/8-04		R1/2	15	79.5	71.5	24								142		20.9

unit:inch

MODEL	Tube dia. φ	NPT	A	B	L	φP	C	J1	J2	E	H1	H2	Weight (G)	Orifice φMM	Eff.a. φmm ²	CV
PAT5/32-N1U	5/32	NPT1/8	0.31	2.24	2.09	0.39	0.59	0.39	0.55	0.87	0.55	9/16	44.0	3	4.8	0.26
PAT5/32-N2U	5/32	NPT1/4	0.43	2.36	2.13	0.39	0.59	0.39	0.55	0.87	0.55	9/16	46.9	3	4.4	0.24
PAT1/4-N1U	1/4	NPT1/8	0.31	2.24	2.09	0.49	0.67	0.47	0.55	1.04	0.55	9/16	49.3	5	7.0	0.38
PAT1/4-N2U	1/4	NPT1/4	0.43	2.36	2.13	0.49	0.67	0.47	0.55	1.04	0.55	9/16	52.3	5	7.2	0.39
PAT1/4-N3U	1/4	NPT3/8	0.47	2.44	2.19	0.49	0.67	0.47	0.55	1.04	0.55	11/16	63.2	5	7.1	0.38
PAT5/16-N2U	5/16	NPT1/4	0.43	2.52	2.24	0.57	0.73	0.55	0.59	1.16	0.67	11/16	74.7	6	13.5	0.73
PAT5/16-N3U	5/16	NPT3/8	0.47	2.56	2.26	0.57	0.73	0.55	0.59	1.16	0.67	11/16	80.7	6	13.9	0.75
PAT5/16-N4U	5/16	NPT1/2	0.59	2.76	2.30	0.57	0.73	0.55	0.59	1.16	0.67	7/8	102.1	6	14.0	0.76
PAT3/8-N2U	3/8	NPT1/4	0.43	2.97	2.74	0.69	0.81	0.67	0.71	1.34	0.87	7/8	128.8	8	20.5	1.11
PAT3/8-N3U	3/8	NPT3/8	0.47	3.01	2.76	0.69	0.81	0.67	0.71	1.34	0.87	7/8	133.7	8	20.8	1.13
PAT3/8-N4U	3/8	NPT1/2	0.59	3.13	2.81	0.69	0.81	0.67	0.71	1.34	0.87	7/8	142.1	8	20.9	1.13

PY

Union Y

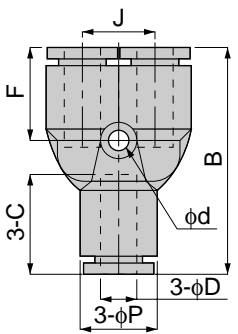

unit:mm

Model	Tube dia. φD	B	φP	C	J	φd	F	Mass (g)	Orifice (φmm)	Eff. a. (mm ²)
PY 4	4	33.5	10	15	11	3.2	14.5	8	3	4.2
PY 6	6	38	13	17	12	3.2	16	10.5	4.6	10
PY 8	8	43	15	18.5	14	3.2	17.5	15.5	6	16.5
PY 10	10	49	18	20.5	18	4.5	20	25.5	7.5	27
PY 12	12	55	21.5	23.5	20	4.5	22.5	37	9	38
PY 16	16	63	24.5	24.5	24	4.5	22.5	44	13	56.5
PY 1/4	1/4	38	13	17	12	3.2	16	10.5	4.6	10
PY 5/16	5/16	43	15	18.5	14	3.2	17	15.5	6	16.5
PY 3/8	3/8	49	18	20.5	18	4.5	19.5	25.5	7.5	27



PW

Different Diam. Union Y

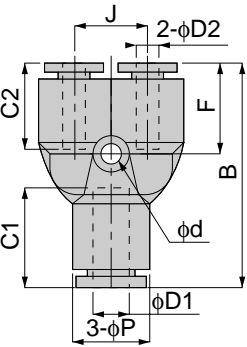

unit:mm

Model	Tube dia. φD1	Tube dia. φD2	B	φP	C1	C2	φd	F	Mass (g)	Orifice (φmm)	Eff. a. (mm ²)
PW 6-4	6	4	37.5	13	17	15	3.2	15.5	10.5	3	4.2
PW 8-6	8	6	42.5	15	18.5	17	3.2	17.5	14.5	4.6	10
PW 10-8	10	8	48.5	18	20.5	18.5	4.2	19.5	23	6	16.5
PW 12-10	12	10	55	21.5	23.5	20.5	4.2	22.5	35.5	7.5	27
PW 1/4-4	1/4	4	37.5	13	17	15	3.2	15.5	10.5	3	4.2
PW 5/16-1/4	5/16	1/4	42.5	15	18.5	17	3.2	17.5	14.5	4.6	10
PW 3/8-5/16	3/8	5/16	48.5	18	20.5	18.5	4.2	19.5	23	6	16.5

